

# Collet-Lok®

Enerpac Collet-Lok® products combine the automation of hydraulic actuation with the security of an internal locking mechanism. After actuation and locking, these products maintain their clamping or supporting capacity without maintaining hydraulic pressure in the circuit. Available in Swing, Push, and Work Supports models, Enerpac Collet-Lok® products are also available in numerous special configurations and modifications.

## Technical support

Refer to the “Yellow Pages” of this catalog for:

- Safety instructions
- Basic hydraulic information
- Advanced hydraulic technology
- FMS (Flexible Machining Systems) technology
- Conversion charts and hydraulic symbols

 197 ▶



### Swing Clamps

Enerpac Collet-Lok® Swing Clamps combine the rotational actuation and clamping force of a hydraulic Swing Clamp with an internal locking mechanism that maintains the applied clamping force without holding hydraulic pressure in the clamp. Ideal for use in large-scale fixtures, they are available in 4,4, 8,9 and 37,8 kN models. Standard models are available in either Threaded Body or Lower Flange configurations. Available modifications include flange top manifold porting, longer strokes, non-rotational versions and special design bodies. Viton seals are standard.



### Work Supports



Enerpac Collet-Lok® Work Supports use internal spring force to lift the support rod into contact with the work piece and then maintain the support with an internal locking system. Cataloged in 8,9, 17,8, and 44,5 kN capacities, these products are available in Threaded Body (8,9 and 17,8 kN only) and Lower Flange models (8,9, 17,8, and 44,5 kN). Available modifications include longer strokes, flange top manifold porting, and special design bodies. Viton seals are standard.



### Push Cylinders

Enerpac Collet-Lok® Push Cylinders are designed for either clamping or supporting applications. The clamping or supporting force is maintained once the internal lock is engaged. Available in either 11,1 or 22,2 kN capacities, these cylinders are available in both Threaded Body or Lower Flange models. Available modifications include flange top manifold porting, longer strokes, and special design bodies. Viton seals are standard.

# Products

	▼ series	▼ page	
<b>Collet-Lok® cylinder range overview</b>		<b>10-11</b>	
Collet-Lok® Swing clamps	MPF, MPT	12-15	
Collet-Lok® Work supports	MPFS, MPTS	16-17	
Collet-Lok® Push cylinders	MPFC, MPTC	18-19	



Shown: MPTC-110, MPFL-50V, MPFC-210, MPTS-100, MPFS-100



▶ Enerpac Collet-Lok® cylinders are designed to mechanically hold the workpiece after hydraulic pressure is removed. Clamping capacities range from 4,4 to 37,8 kN.

■ MPTL-100 and MPTR-100 Collet-Lok® Swing Clamps are used to securely clamp these exhaust manifolds.



## Hydraulic actuation with mechanical lock

- Collet-Lok® technology combines hydraulic actuation for clamping or supporting with an internal locking collet
- Clamp bodies are available in either threaded mount or flange mount
- Flange mount units feature both tubing ports and bottom manifold ports
- Flange top manifold ports available as a special
- VITON seals are standard.

## Collet-Lok® Designs:

### Collet-Lok® Swing Clamps

- Available in 4,4, 8,9 and 37,8 kN models
- Available in Right Hand or Left Hand Swing and Straight (guided) models.

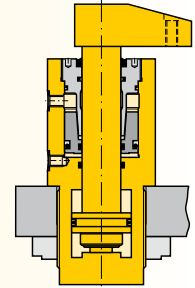

▣ 12-15 ▶

### Collet-Lok® Work Supports

- Available in 4,4, 17,8 and 44,5 kN models
- Spring advance design to maintain contact with the work piece.

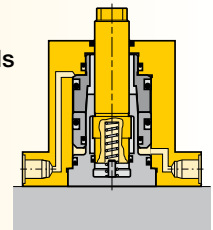

▣ 16-17 ▶

### Collet-Lok® Push Cylinders

- Available in 11,1 and 22,2 kN models
- Designed for Push only
- Can be used as a heavy-duty Work Support.

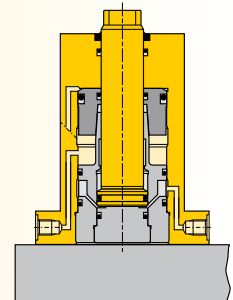

▣ 18-19 ▶

## Why use Collet-Lok®?

Collet-Lok® technology from Enerpac combines hydraulic actuation with mechanical locking to provide the automation and control of hydraulics and the long term security of a mechanical lock. Available in Swing Clamps, Push Cylinders and Work Supports, Collet-Lok® is a unique solution that is well suited to today's demanding manufacturing environment.

## Collet-Lok® Clamping and Unclamping Cycle

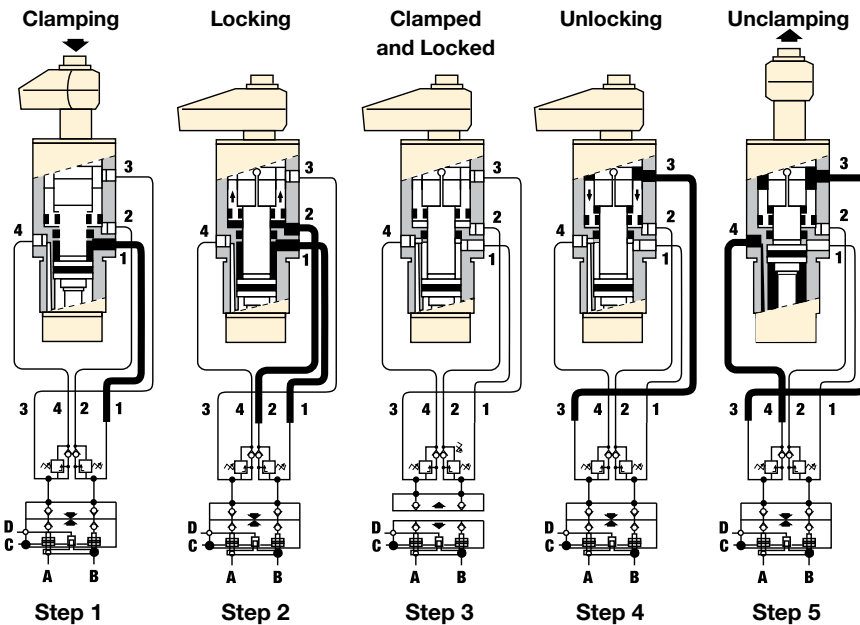

**MPTR-100** Collet-Lok® swing cylinder

- 1 = 90° Rotation + Clamp
- 2 = Lock
- 3 = Unlock
- 4 = Unclamp + 90° Rotation

**MCA-62, MPA-62** Auto coupler

- A = Pressure line from pump to swing cylinder
- B = Pressure line from pump to swing cylinder
- C = Auto coupler advance
- D = Auto coupler retract

## How Does Collet-Lok® Work?

The ports on Collet products are conveniently labeled in the order that they are used during a clamping or unclamping cycle.

The typical Collet-Lok® circuit pairs the Clamp circuits with the Lock circuits by using a sequence valve to delay the Lock function until the clamping pressure is almost reached. When unclamping, the Unlock and Unclamp circuits are also paired with a sequence valve so the Lock is released before the clamp extends to Unclamp. An alternate approach to controlling these circuits is to use a PLC to operate individual valves for the Clamp/Unclamp and Lock/Unlock functions.

Because Collet-Lok® provides a mechanical lock to hold the clamping force onto the work piece, support components used in standard hydraulic clamping circuits such as pilot operated check valves and accumulators are not needed. In typical applications, the hydraulic circuit in a fixture with Collet-Lok® clamps is de-pressurized after the clamping cycle is completed. This allows for complete security during the machining cycle, or if the work pieces are pre-clamped and staged in a pallet pool for extended periods of time.

[www.enerpacwh.com](http://www.enerpacwh.com)

Force: 4,4 - 37,8 kN

Stroke: 24,0 - 42,0 mm

Pressure: 100 - 350 bar

## Collet-Lok® Sequence:

### Step 1

2-passage Auto coupler connects external power source with pallet receiver and the Collet-Lok® cylinder is activated for hydraulic clamping.

### Step 2

After reaching maximum clamping pressure the sequence valve is opened and actuates the internal wedge hydraulically.

### Step 3

The wedge system secures the plunger position mechanically and the hydraulic pressure is taken off, then the auto coupler retracts. The work piece on the pallet is now securely clamped, without being connected to a power source.

### Step 4

After being in the machine the pallet returns to the loading and unloading position and the auto coupler is connected again to release the wedge.

### Step 5

The hydraulic plunger is now retracted and the pallet is free for unloading and loading.

## Options

Collet-Lok® swing clamps

12 ▶



Collet-Lok® work supports

16 ▶



Collet-Lok® push cylinders

18 ▶



# Swing cylinders - Collet-Lok® design

Shown: MPTR-100V, MPFR-100V



## MP series

Enerpac Collet-Lok® cylinders are designed to mechanically hold the workpiece after hydraulic pressure is removed. Clamping capacities range from 4,4 to 37,8 kN.

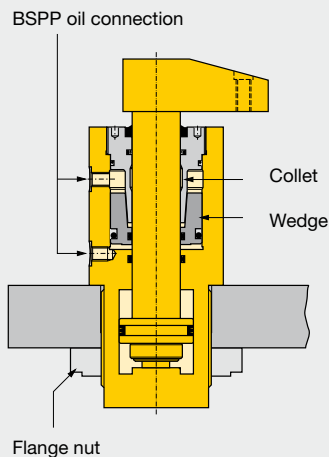

Hydraulic pressure pushes the collet up a wedge, locking the plunger in the clamping position.

### Lower flange Collet-Lok® swing cylinder mounted on a pallet.



## Ideal when live hydraulics are not available

- Double acting Collet-Lok® action allows fully automated operation
- Additional level of safety since live hydraulics are not required to maintain clamping force
- Collet-Lok® swing cylinders can be mounted by the flange or threaded into the fixture. Flanged models have manifold ports and tubing ports.
- Viton seals are standard.

## Selection chart

Clamping force <sup>1)</sup>	Stroke		Left turning	Right turning	Cylinder effective area		Oil capacity		Max. oil flow <sup>1)</sup>	Standard clamp arm
	kN	mm			cm <sup>2</sup>	cm <sup>3</sup>				
	Clamp	Total			Clamp	Un-clamp	Clamp	Un-clamp	l/min	Sold separately
			90°							
<b>▼ Lower flange</b>										
			Model number							
4,4	8	24,2	MPFL-50V	MPFR-50V	1,6	4,5	3,9	10,9	0,5	MA-540
8,9	12	28,2	MPFL-100V	MPFR-100V	3,2	7,1	9,0	19,9	1,0	MA-1050
37,8	10	42	MPFL-300V*	MPFR-300V*	13,2	22,2	55,7	93,4	4,0	MA-3070
<b>▼ Threaded body</b>										
			Model number							
8,9	12	28,2	MPTL-100V	MPTR-100V	3,2	7,1	9,0	19,9	0,5	MA-1050
37,8	10	42	MPTL-300V*	MPTR-300V*	13,2	22,2	55,7	93,4	4,0	MA-3070

<sup>1)</sup> Using standard clamp arm. Clamp arms are sold separately (14).

**Note:** - Call Enerpac for models with UNF thread and SAE port connections.  
- Minimum working pressure for Collet-Lok® system is 100 bar.

\* This product is made to order. Please contact Enerpac for delivery information before specifying in your design.

## Collet-Lok® sequence

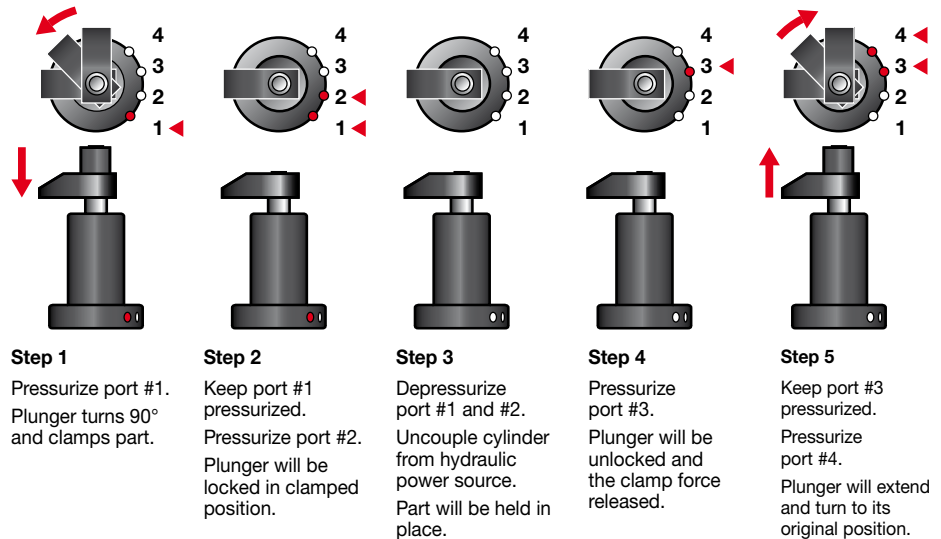

## Product dimensions in mm [ ]

Left turning models *	A	B	C	C1	D	D1	F	H1	H2	H3
					Ø	Ø	Ø			
<b>▼ Lower flange</b>										
MPFL-50V	201,2	177	171,2	25	58	85	19	10	12,5	-
MPFL-100V	222,9	194,7	192,9	25	68	100	22,3	10	12,5	-
MPFL-300V	322	280	275	25	89,8	130	34,9	11	12,5	-
<b>▼ Threaded body</b>										
MPTL-100V	213,2	185	121,3	90,5	M48 x 1,5	64	22,3	31,5	67	75,5
MPTL-300V	310,5	268,5	163	115	M80 x 2,0	89	34,9	38	92	100,5

**Note:** Dimensions shown with standard clamp arm.

\* For nonrotational model replace "L" with "N". Example: MPFN-100V.



## Installation dimensions in mm

Clamping force <sup>1)</sup> kN	Fixture hole Ø D3	Mounting thread J mm	Minimum depth J2
------------------------------------	----------------------	-------------------------	---------------------

### ▼ Lower flange

4,4	58,4 ±0,3	M6 x 1	18
8,9	68,6 ±0,3	M8 x 1,25	19
37,8	90,5 ±0,3	M10 x 1,5	19

Clamping force <sup>1)</sup> kN	Fixture hole Ø D3	Mounting flange Sold separately □ 87 ▶	Mounting nut Sold separately □ 86 ▶
------------------------------------	----------------------	---	--

### ▼ Threaded body

8,9	M48 x 1,5	MF-482	FN-482
37,8	M80 x 2	MF-802	FN-802

<sup>1)</sup> With standard clamp arm.

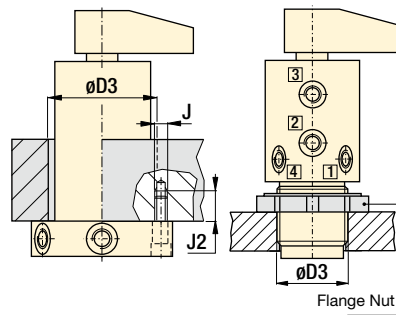

## Oil port functions

- 1 90° Rotation and clamp
- 2 Locks system
- 3 Unlocks system
- 4 Unclamp and 90° rotation

Force: 4,4 - 37,8 kN

Stroke: 24,0 - 42,0 mm

Pressure: 100 - 350 bar

- E** Cilindros giratorios
- F** Vérins de bridage pivotants
- D** Schwenkspannzylinder

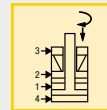

## Custom Options Available

Intermediate capacities

Different flange locations

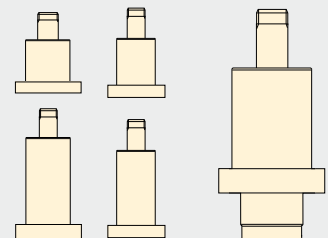

## MPF models

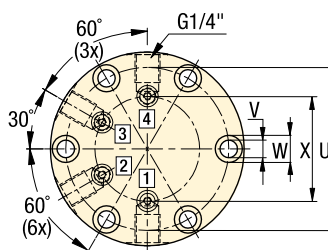
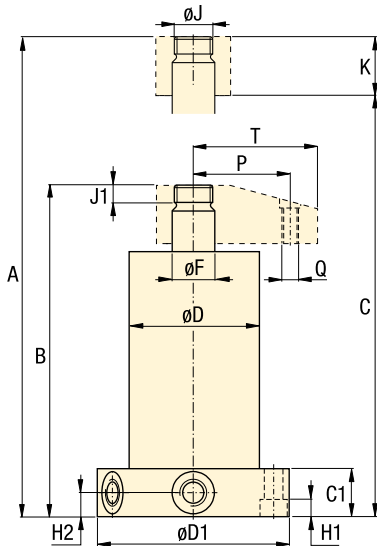

## MPT models

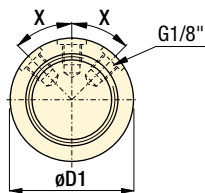
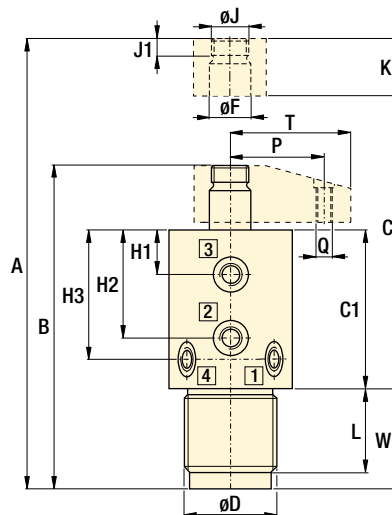

X = 45° MPT-100 models

X = 30° MPT-300 models

	J	J1	K	L	P	Q	T	U	V	W	X	Right turning models	
								Ø	Ø	Ø	kg		
<b>Lower flange ▼</b>													
	M16 x 1,5	8	30	-	40	M8 x 1,25	54	70,1	9	Ø 14	48,0	2,3	MPFR-50V*
	M20 x 1,5	9	30	-	50	M10 x 1,5	64	84,1	9	Ø 14	54,1	3,5	MPFR-100V*
	M33 x 2,0	10	47	-	70	M16 x 2	93	112,1	11	Ø 17	96,1	12,0	MPFR-300V*
<b>Threaded body ▼</b>													
	M20 x 1,5	9	30	41,5	50	M10 x 1,5	64	-	-	61,9	-	3,0	MPTR-100V*
	M33 x 2,0	10	47	85	70	M16 x 2	93	-	-	99,5	-	11,0	MPTR-300V*

**Flexible Machining Systems**  
See Yellow Pages (□ 224)

## Options

**Clamp arms** □ 14 ▶

**Collet-Lok® work supports** □ 16 ▶

**Sequence valves** □ 152 ▶

**Accessories** □ 86 ▶

## Important

Minimum unlock pressure must be at least 105 bar above lock pressure.

# Swing cylinders, MA-series *Dimensions & options*

Force: 4,4 - 37,8 kN

Pressure: 100 - 350 bar

- E** Brazos de amarre
- F** Bras de bridage
- D** Spannarme

## Important

Do not exceed maximum oil flow. If flow rates are exceeded, swing cylinder indexing mechanism may be permanently damaged.

When designing custom clamp arms, the flow rates must be further reduced. This rating should be in proportion to the mass and the center of gravity of the clamp arm.

**Example:**  
If the mass of the arm is twice that of the long arm, flow rates must be reduced by 50%.

Index mechanism

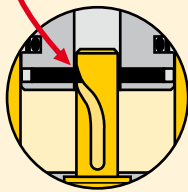

## Options

### Gauges

□190 ▶



### Flow control valves

□155 ▶



### Sequence valves

□152 ▶



## **i** Determine the right size of your Collet-Lok® swing cylinder

The maximum operating pressure, clamping force and length of the clamp arm will determine your size of swing cylinder. The real operating pressure is a function of both the clamp arm length and clamping force.

In the diagrams below you select the required clamp arm length and clamping force. The use of different length clamp arms requires reduction in applied pressure and resulting clamp force. The diagrams below show this relation.

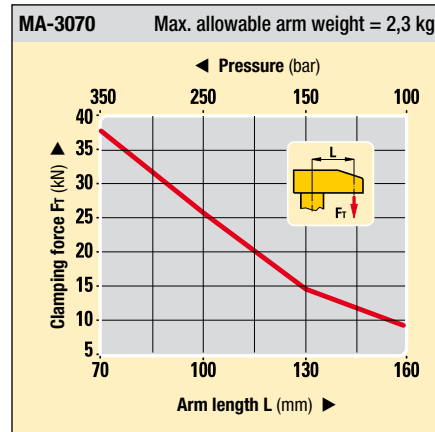
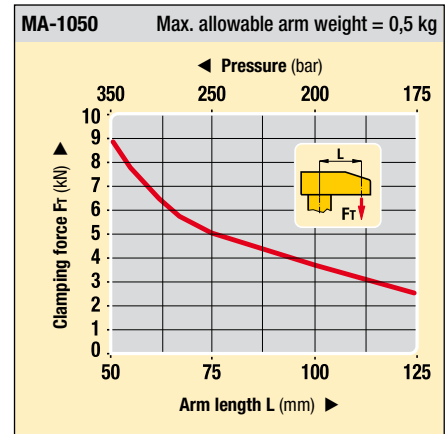
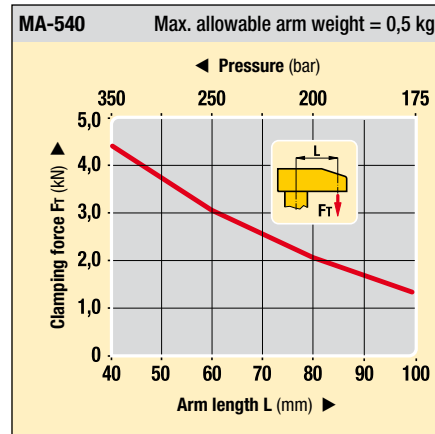

### MA models Standard clamp arms for Collet-Lok® swing clamps

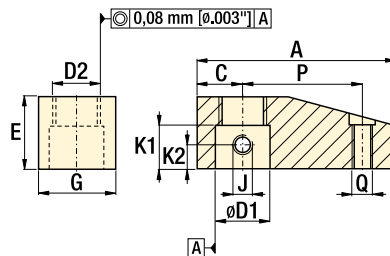

## **A** Product dimensions in mm [ ]

Clamp. force kN	Model number	A	C	D1 ø	D2	E	G	J	K1	K2	P	Q	kg
-----------------	--------------	---	---	---------	----	---	---	---	----	----	---	---	----

### ▼ Standard clamp arms for Collet-Lok® swing clamps

4,4	<b>MA-540</b>	74,7	18,0	19,02-19,05	M16 x 2	30	32	M8 x 1,25	19	10	40	M8 x 1,25	0,5
8,9	<b>MA-1050</b>	83,0	19,0	22,30-22,33	M20 x 1,5	30	35	M8 x 1,25	18	10	50	M10 x 1,5	0,5
37,8	<b>MA-3070</b>	128,0	35,0	34,97-35,00	M33 x 2	47	59	M8 x 1,25	32	17	70	M16 x 2	2,3

**i** Special configurations are available

**Model: MPFL100PE001-S**

**Body style:** Upper flange

**Clamp capacity:** 9 kN (2000 lbs)

**Clamping stroke:** 18 mm (.71 in.)

**Special feature:** Position sensing

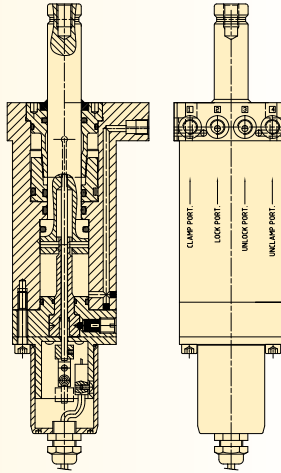

**Special features for Swing Cylinders \***

Enerpac can design Collet-Lok® cylinders with special features to meet the needs of your production fixtures:

- Special mounting
- Special manifold port location
- Longer stroke
- Special rotation
- Internal clutch to protect rotation mechanism
- Viton seals
- Special rod end
- Position sensing

\* Special features also available for Collet-Lok® Push Cylinders and Work Supports.

**Model: MPFN300VE002**

**Body style:** Lower flange

**Clamp capacity:** 39 kN (8800 lbs)

**Clamping stroke (straight):**  
57,4 mm (2.25 in.)

**Special feature:** Viton seals  
Long stroke

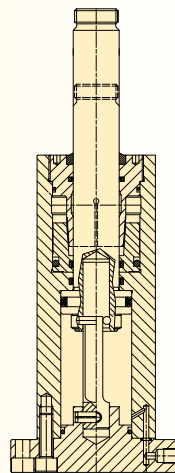

**Model: MPFL200VE100**

**Body style:** Mid-body flange

**Clamp capacity:** 20 kN (3900 lbs)

**Clamping stroke (left hand):**  
63,5 mm (2.50 inch)

**Special feature:** Viton seals  
Long stroke  
Mid-flange body

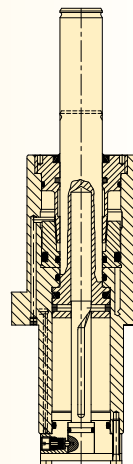



# Work supports - Collet-Lok® design

Shown: MPFS-100, MPTS-100



## MP series

Enerpac work supports provide either additional non-fixed location points to the clamps, or support to larger or thin section workpiece components, always in order to minimize workpiece deflection during machining. The *Collet-Lok*® design does not require hydraulic system pressure to maintain support position.

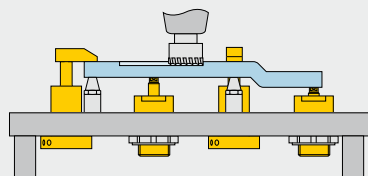

While pallet No. 1 is in the machine, a new work piece is loaded on to pallet No. 2.



## Hydraulically locked, mechanically maintained work support

- *Collet-Lok*® design allows the work support to maintain support position after the hydraulic pressure is removed
- *Collet-Lok*® maintains a higher level of safety, as it is not dependent on hydraulic supply pressure
- Low deflection: lowest deflection of any work support available
- Threaded or flanged body increases mounting flexibility
- Capacities up to 44,5 kN available.

## Collet-Lok® sequence

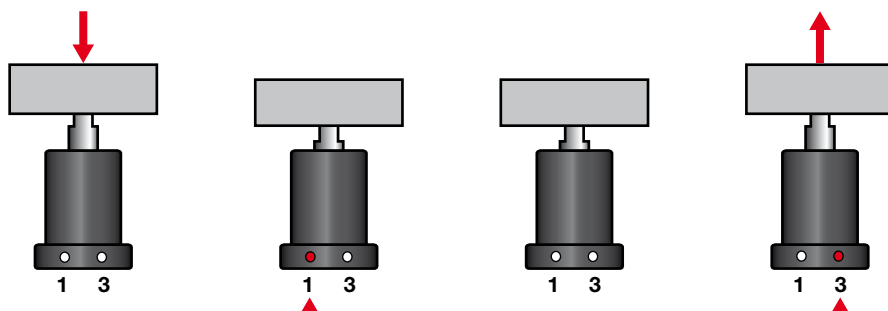

**Step 1**  
Install the workpiece on the support cylinder. The plunger position will adjust to the contour of the workpiece.

**Step 2**  
Pressurize oil port #1. The plunger will be locked in the supporting position.

**Step 3**  
Depressurize oil port #1. Cylinder can be uncoupled from hydraulics and still support the workpiece.

**Step 4**  
Pressurize oil port #3. The plunger will be unlocked. When the workpiece is removed, plunger will extend into its original position.

## Mounting style

### MPT series, Threaded mount

Threaded body can be used with a threaded hole in fixture plate or a jam nut with a bored hole. Ports are located in top collar block.

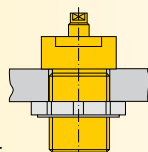

### MPF series, Flange models

Mounts directly to fixture plate. Offers the flexibility of side ports or manifold ports on the underside of the flange.

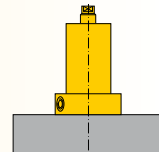

## Product selection

Max. support force	Support plunger stroke	Flange models	Threaded models	Operating pressure		Locking system displacement		Plunger contact spring force	Max. oil flow
				min.	max.	lock	unlock		
8,9	10	MPFS-100V	-	100	350	3,93	3,93	20,0	0,5
17,8	10	MPFS-200V	-	100	350	6,06	6,06	35,2	1,0
44,5	19,6	MPFS-450V	-	100	350	18,03	18,03	300,4	4,0
8,9	10	-	MPTS-100V	100	350	3,93	3,93	15,0	0,5
17,8	10	-	MPTS-200V	100	350	6,06	6,06	30,0	1,0

Force: 8,9 - 44,5 kN

Stroke: 10 - 19,6 mm

Pressure: 100 - 350 bar

- E** Cilindros de soporte
- F** Vérin anti-vibreur
- D** Abstützylinder

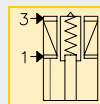

**Options**

Collet-Lok® swing cylinders

12



Auto couplers

174



Positive clamping cylinders

80



Sequence valves

152



**Important**

**WARNING!**

Support force and clamping force must be matched. Support force should be at least 150% of clamping force.

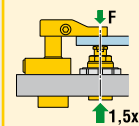

For proper application, clamp force, pressures and timing, consult Enerpac for support.

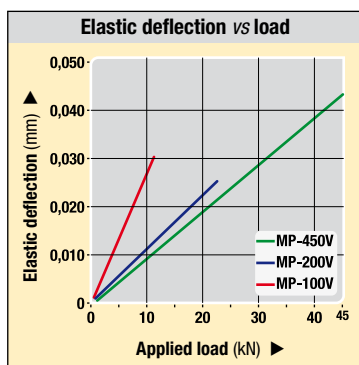
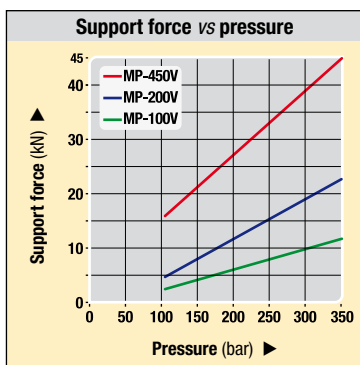

**Deflection chart:**

Elastic deformation of the work support resulting from the application of load.

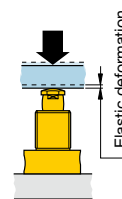

**MPFS-100V, -200V**

**MPFS-450V**

**MPTS-100V, -200V**

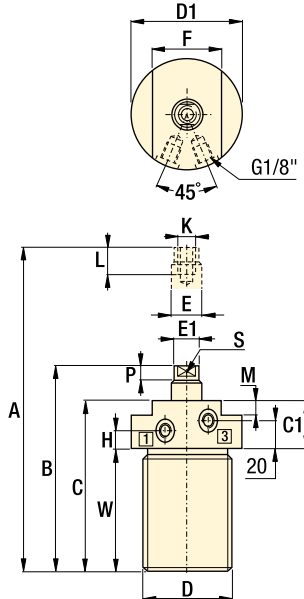
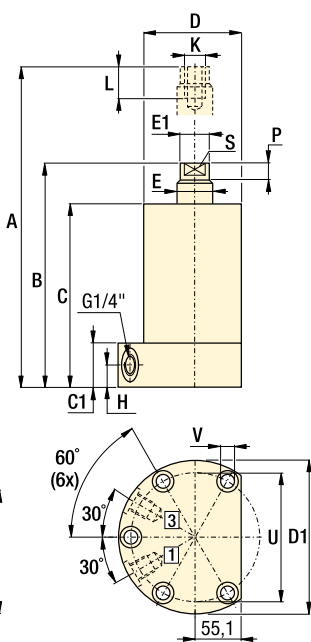
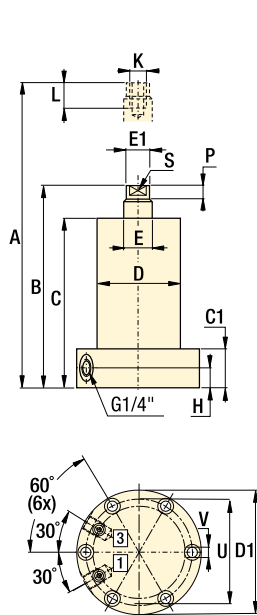

**Product dimensions** in mm [  $\pm$  ]

Model number	A	B	C	C1	D	D1	E	E1	F	H	K	L	M	P	S*	U	V	W	X	kg
						Ø	Ø	Ø								Ø	Ø		Ø	
<b>▼ Flange models</b>																				
<b>MPFS-100V</b>	126	116	106	25	Ø 76	110	15,9	14	-	12,5	M8 x 1,25	15	-	7	2,8	94,1	9	-	81,5	4,0
<b>MPFS-200V</b>	130	120	106	25	Ø 92	130	25	24	-	12,5	M12 x 1,75	20	-	9	2,8	112,1	9	-	97,1	6,0
<b>MPFS-450V</b>	193,4	173,8	161	25	Ø 130	165	50	48	-	12,5	M20 x 2	30	-	10	30 **	147	11	-	125	16,0
<b>▼ Threaded models</b>																				
<b>MPTS-100V</b>	125	115	105	38	M60 x 2	69	15,9	14	55	15,5	M8 x 1,25	15	20	7	2,8	-	-	67	-	3,0
<b>MPTS-200V</b>	129	119	105	38	M80 x 2	89	25	24	70	15,5	M12 x 1,75	20	20	9	2,8	-	-	67	-	4,0

\* 2x spanner holes Ø 2,8 mm for MPFS-100 and 200 models.

\*\* Wrench Flats for MPFS-450.

# Push cylinders - Collet-Lok® design

Shown: MPTC-110, MPFC-210



## MP series

Collet-Lok® positive locking push cylinders are designed to mechanically hold the workpiece after hydraulic pressure is removed. Push capacities range from 11,1 kN to 22,2 kN.

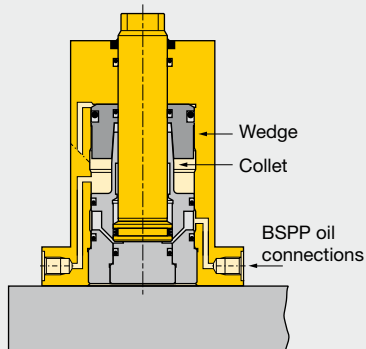

Hydraulic pressure pushes the collet up a wedge, locking the plunger in the clamping position.

Lower flange Collet-Lok® push cylinder used for positioning a motorcycle frame.



Ideal when live hydraulics are not available

...clamping is sustained mechanically so live hydraulics are not required during the machining cycle

- Double-acting Collet-Lok® action allows fully automated operation
- Additional level of safety since live hydraulics are not required
- Collet-Lok® push cylinders can either be mounted by the flange, or threaded into the fixture
- The Collet-Lok® design is an industry exclusive
- Capacities up to 39,9 kN available on request.

## Collet-Lok® sequence

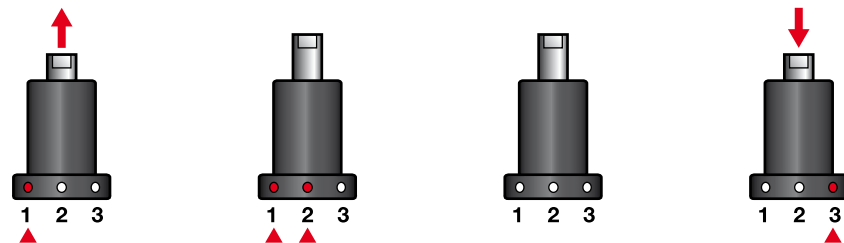

### Step 1

Pressurize port #1. Plunger extends and clamps workpiece.

### Step 2

Keep port #1 pressurized. Pressurize port #2. Plunger will be locked in clamped position.

### Step 3

Depressurize port #1 and #2. Cylinder should now be uncoupled from hydraulic power source and will maintain the clamped position.

### Step 4

Pressurize port #3. Plunger will be unlocked and the plunger will be released to its original position.

## Product selection

Max. push force	Hydr. plunger stroke	Lower flange	Threaded body	Operating pressure		Hydraulic effective area		Oil capacity		Max. oil flow
				bar min.	bar max.	cm <sup>2</sup> adv.	cm <sup>2</sup> adv.	cm <sup>3</sup> unlock	cm <sup>3</sup> retr.	
11,1	15,3	MPFC-110V	MPTC-110V	50	350	3,23	4,92	6,06	3,93	2,0
22,2	15,2	MPFC-210V	MPTC-210V	50	350	6,39	10,00	10,00	6,06	4,0

Maximum cycle rate: 8 cycles/min.

Note: Call Enerpac to order models with UNF thread and SAE port connections. Capacities up to 39,9 kN available on request.

## Dimensions in mm [ $\varnothing$ ]

Model number	A	B	C	C1	D	D1	D2	E	E1	F
						$\varnothing$		$\varnothing$	$\varnothing$	$\varnothing$
▼ Lower flange										
MPFC-110V	155,8	140,5	131	-	$\varnothing$ 70,0	100	-	15,8	15	-
MPFC-210V	176,7	161,5	149	-	$\varnothing$ 78,0	110	-	22,2	20	-
▼ Threaded body										
MPTC-110V	154,8	139,5	130	18,5	M60 x 2	60	M36 x 1,5	15,8	15	46
MPTC-210V	175,7	160,5	148	18	M70 x 2	70	M48 x 1,5	22,2	20	55

**Installation dimensions** in mm

Push force kN	Fixture hole ø D3	Mounting thread J	Minimum depth J2
<b>▼ Lower flange</b>			
11,1	71	M6 x 1,0	17
22,2	79	M8 x 1,0	18
<b>▼ Threaded body</b>			
11,1	M60 x 2	-	-
22,2	M70 x 2	-	-

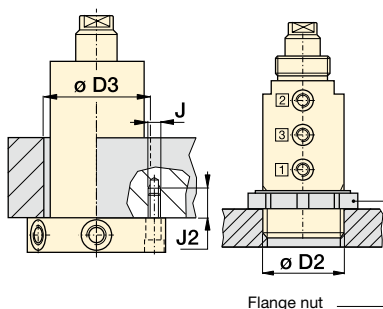

<b>Force: 11,1 - 22,2 kN</b>
<b>Stroke: 15,0 mm</b>
<b>Pressure: 50 - 350 bar</b>

- E** Cilindros de empuje
- F** Vérins pousseurs
- D** Gesicherter Druckzylinder

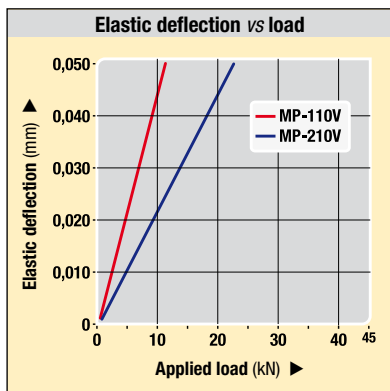
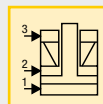

**Deflection chart:**

Elastic deformation of the plunger resulting from the application of load.

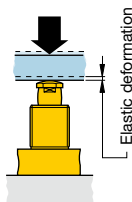

**Custom Options Available**

- Intermediate capacities
- Different flange locations

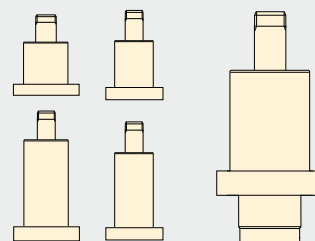

**MPFC**

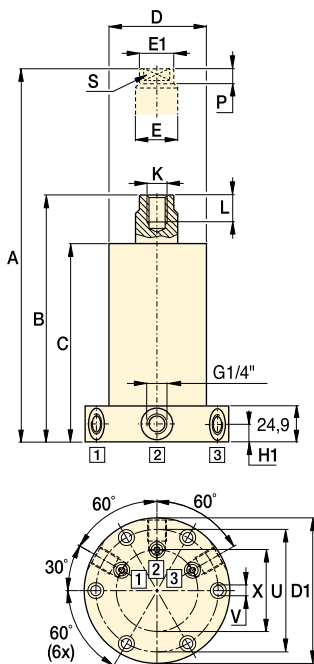

**Oil port functions**

- 1** Clamp
- 2** Lock
- 3** Unlock/Retract

**MPTC**

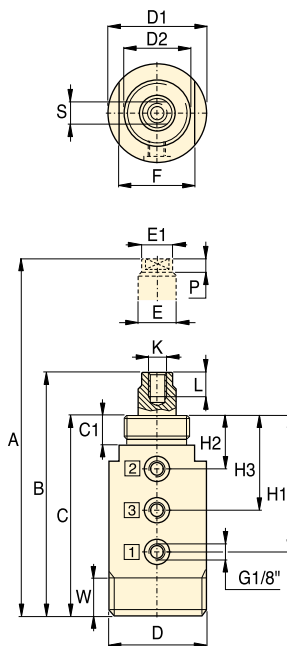

H1	H2	H3	K	L	P	S*	U	V	W	X	kg	Model number
<b>Lower flange ▼</b>												
12,5	-	-	M8 x 1,25	15	7,0	12,0	84,1	7	-	56,1	4,0	<b>MPFC-110V</b>
12,5	-	-	M10 x 1,5	20	8,7	16,0	94,0	9	-	70,0	5,0	<b>MPFC-210V</b>
<b>Threaded body ▼</b>												
96,0	33,0	64,5	M8 x 1,25	15	7,0	12,0	-	-	19	-	3,0	<b>MPTC-110V</b>
111,0	32,5	72,0	M10 x 1,5	20	8,7	16,0	-	-	20	-	3,4	<b>MPTC-210V</b>

\* Spanner holes (x 2)

**Options**

- Auto couplers** 174 ▶
- Sequence valves** 152 ▶
- Accessories** 86 ▶
- Collet-Lok® swing cylinders** 12 ▶

**Important**

For proper application, clamp force, pressures and timing, consult Enerpac for support.