

Swing cylinders - Collet-Lok® design

Shown: MPTR-100V, MPFR-100V



MP series

Enerpac Collet-Lok® cylinders are designed to mechanically hold the workpiece after hydraulic pressure is removed. Clamping capacities range from 4,4 to 37,8 kN.

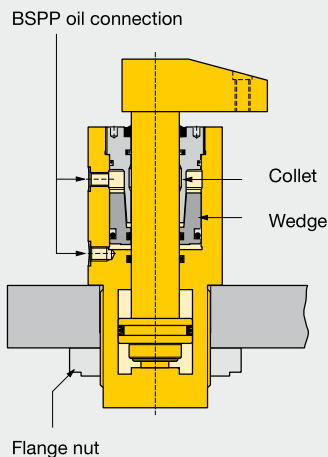

Hydraulic pressure pushes the collet up a wedge, locking the plunger in the clamping position.



Lower flange Collet-Lok® swing cylinder mounted on a pallet.



Ideal when live hydraulics are not available

- Double acting Collet-Lok® action allows fully automated operation
- Additional level of safety since live hydraulics are not required to maintain clamping force
- Collet-Lok® swing cylinders can be mounted by the flange or threaded into the fixture. Flanged models have manifold ports and tubing ports.
- Viton seals are standard.

Selection chart

Clamping force ¹⁾ kN	Stroke mm		Left turning 	Right turning 	Cylinder effective area cm ²		Oil capacity cm ³		Max. oil flow ¹⁾ l/min	Standard clamp arm Sold separately
	Clamp	Total			Clamp	Un-clamp	Clamp	Un-clamp		
▼ Lower flange										
			Model number							
4,4	8	24,2	MPFL-50V	MPFR-50V	1,6	4,5	3,9	10,9	0,5	MA-540
8,9	12	28,2	MPFL-100V	MPFR-100V	3,2	7,1	9,0	19,9	1,0	MA-1050
37,8	10	42	MPFL-300V*	MPFR-300V*	13,2	22,2	55,7	93,4	4,0	MA-3070
▼ Threaded body										
			Model number							
8,9	12	28,2	MPTL-100V	MPTR-100V	3,2	7,1	9,0	19,9	0,5	MA-1050
37,8	10	42	MPTL-300V*	MPTR-300V*	13,2	22,2	55,7	93,4	4,0	MA-3070

¹⁾ Using standard clamp arm. Clamp arms are sold separately (14).

Note: - Call Enerpac for models with UNF thread and SAE port connections.
- Minimum working pressure for Collet-Lok® system is 100 bar.

* This product is made to order. Please contact Enerpac for delivery information before specifying in your design.

Collet-Lok® sequence

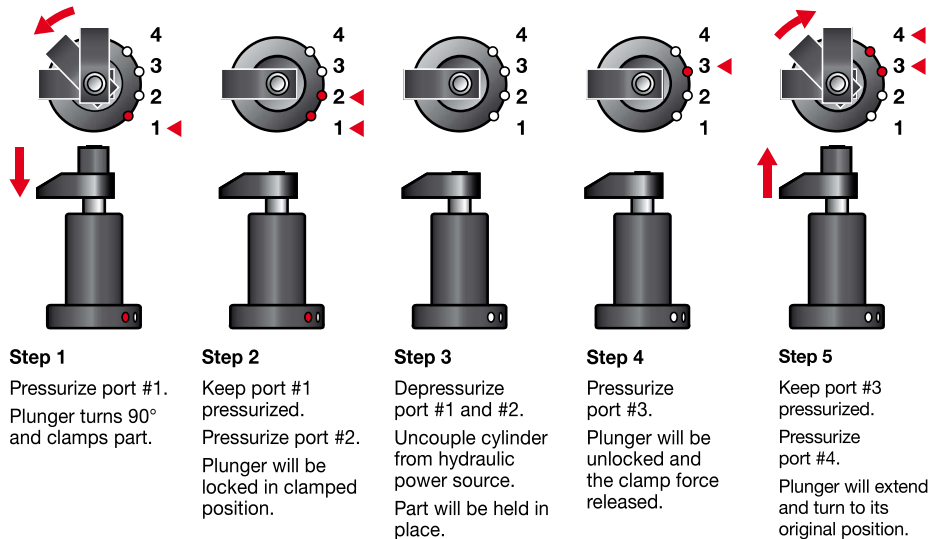

Product dimensions in mm []

Left turning models *	A	B	C	C1	D Ø	D1 Ø	F Ø	H1	H2	H3
▼ Lower flange										
MPFL-50V	201,2	177	171,2	25	58	85	19	10	12,5	-
MPFL-100V	222,9	194,7	192,9	25	68	100	22,3	10	12,5	-
MPFL-300V	322	280	275	25	89,8	130	34,9	11	12,5	-
▼ Threaded body										
MPTL-100V	213,2	185	121,3	90,5	M48 x 1,5	64	22,3	31,5	67	75,5
MPTL-300V	310,5	268,5	163	115	M80 x 2,0	89	34,9	38	92	100,5

Note: Dimensions shown with standard clamp arm.

* For nonrotational model replace "L" with "N". Example: MPFN-100V.

Installation dimensions in mm

Clamping force ¹⁾ kN	Fixture hole Ø D3	Mounting thread J mm	Minimum depth J2
------------------------------------	----------------------	-------------------------	---------------------

▼ Lower flange

4,4	58,4 ±0,3	M6 x 1	18
8,9	68,6 ±0,3	M8 x 1,25	19
37,8	90,5 ±0,3	M10 x 1,5	19

Clamping force ¹⁾ kN	Fixture hole Ø D3	Mounting flange Sold separately □ 87 ▶	Mounting nut Sold separately □ 86 ▶
------------------------------------	----------------------	--	---

▼ Threaded body

8,9	M48 x 1,5	MF-482	FN-482
37,8	M80 x 2	MF-802	FN-802

¹⁾ With standard clamp arm.

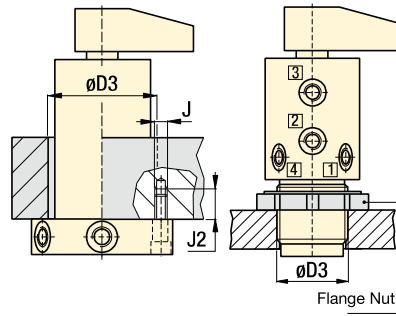

Oil port functions

- 1 90° Rotation and clamp
- 2 Locks system
- 3 Unlocks system
- 4 Unclamp and 90° rotation

MPF models

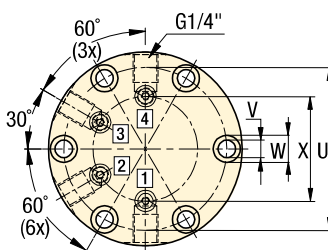
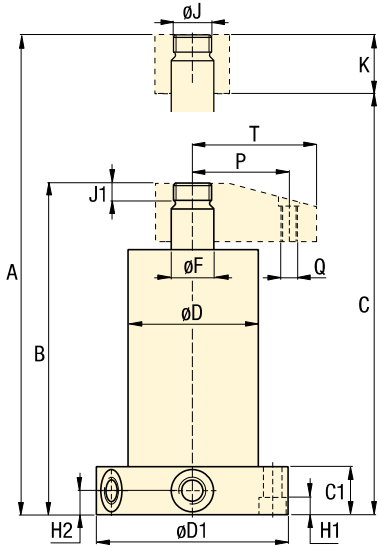

MPT models

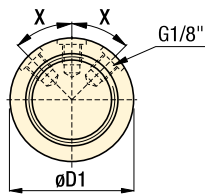
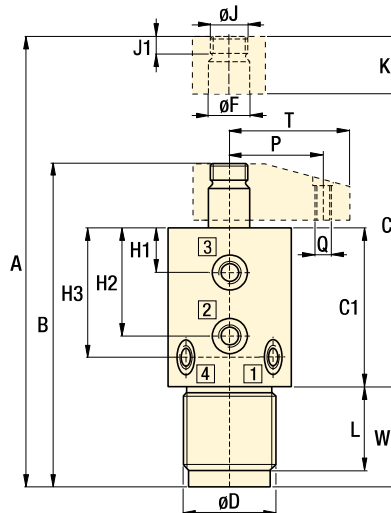

X = 45° MPT-100 models

X = 30° MPT-300 models

Force: 4,4 - 37,8 kN

Stroke: 24,0 - 42,0 mm

Pressure: 100 - 350 bar

- E Cilindros giratorios
- F Vérins de bridage pivotants
- D Schwenkspannzylinder

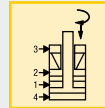

Custom Options Available

Intermediate capacities

Different flange locations

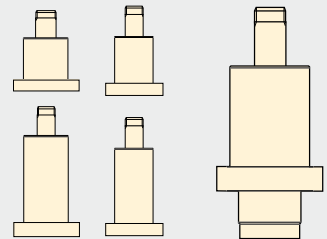

FMS Flexible Machining Systems
See Yellow Pages (□ 224)

Options

Clamp arms
□ 14 ▶

Collet-Lok® work supports
□ 16 ▶

Sequence valves
□ 152 ▶

Accessories
□ 86 ▶

⚠ Important

Minimum unlock pressure must be at least 105 bar above lock pressure.