

Angled arms use deflection to improve clamping

Angled arms

Tip engages part first and contact increases as clamping force is applied.

Eliminates “push” effect caused by straight arms deflecting under load.

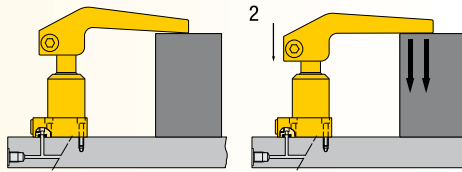

Straight Arms

Great for most applications, but standard deflection can cause part movement and lower the true clamping force.

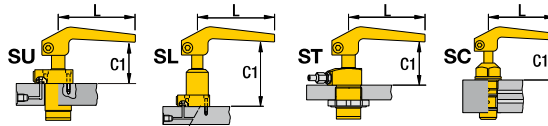
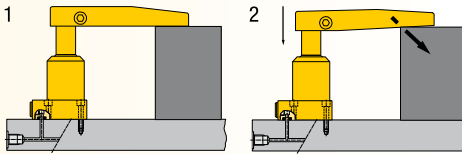



Force: 0,4 - 33,8 kN

Pressure: 35 - 350 bar

- E** Brazos de amarre
- F** Bras de bridage
- D** Spannarme

Options

Sequence valves  [152](#)

Flow control valves  [155](#)

Download CAD files from enerpacwh.com 

Installation dimensions in mm []

Model number	Clamp force	L	SU-Series C1	SL-Series C1	ST-Series C1	SC-Series C1
▼ Stock length dimensions						
CAU-22	0,44	82,5	56,6	109,7	56,6	53,1
CAU-52	0,89	134,8	71,6	137,7	71,6	78,7
CAU-92	2,00	160,0	73,6	149,6	78,7	-
CAU-122	2,22	161,1	83,5	169,4	83,6	91,7
CAU-202	4,45	177,5	88,1	175,3	95,3	-
CAU-352	8,45	180,0	99,0	192,0	106,2	-
▼ Minimum length dimensions						
CAU-22	2,22	25,0	59,7	112,8	59,7	56,1
CAU-52	5,56	40,0	76,7	142,7	76,7	83,8
CAU-92	9,01	45,0	79,9	155,7	84,8	-
CAU-122	11,57	50,8	89,4	175,3	89,4	97,5
CAU-202	18,68	55,0	94,5	181,6	101,6	-
CAU-352	33,81	68,0	106,9	199,9	114,1	-

CAU models Upreach clamp arms

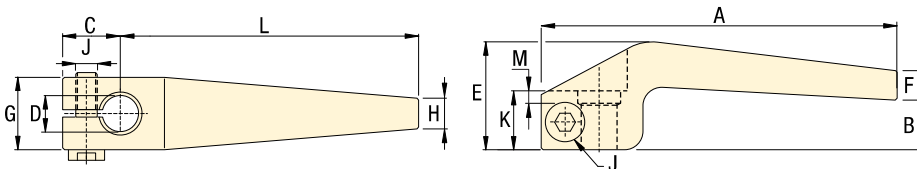

Dimensions in mm []

Model number	A	B	B	C	D	E	F	F	G	H	H	J	K	L	L	M	 kg
		Std.	Min.				Std.	Min.		Std.	Min.			Std.	Min.		
CAU-22	98,5	13,7	16,8	16,0	9,98-10,01	29,7	8,1	13,7	20,0	8,4	20,8	M6 x 1	16,3	82,5	25,0	1,0	0,1
CAU-52	155,0	21,6	26,7	20,0	16,00-16,03	41,9	6,6	14,5	30,0	11,9	31,8	M6 x 1	19,1	135,0	40,0	1,3	0,4
CAU-92	190,0	23,6	29,7	30,0	25,02-25,04	48,0	10,9	19,3	40,0	14,5	40,9	M8 x 1,25	24,9	160,0	45,0	2,3	0,8
CAU-122	190,0	28,2	34,0	28,5	22,25-22,28	57,2	12,7	29,2	38,1	16,5	39,6	M10 x 1,5	30,0	161,5	50,8	3,8	1,0
CAU-202	212,5	32,3	38,6	35,0	32,00-32,03	61,2	13,2	24,4	60,0	17,3	54,4	M10 x 1,5	30,0	177,5	55,0	2,8	1,7
CAU-352	220,0	41,1	49,0	40,0	38,02-38,05	79,8	18,8	34,3	66,0	15,7	54,1	M10 x 1,5	40,1	180,0	68,0	1,8	2,7

Refer to clamping force charts on page 36.
Never cut shorter than indicated minimum length.