

▼ XLP-75 - 25 TON



The Universal Workshop Tool



Easy grip forklift access

Cut-away in lower frame for pallet truck access allows easy transportation of 50 and 75 ton XLP-series presses.



Winch

Movable upper and lower bed with self-braking winch on XLP-Series presses.



Press Kits *

The 50 and 75 ton presses come standard as unassembled kits, and include complete press frame, winch, cylinder, pump with gauge, couplers and hose.

- Side-to-side cylinder movement
- Winch for easy height adjustment of press bed
- Open frame (XLP-50 and XLP-75)
- Electric pumps with remote valve operation.

* 50 and 75 ton XLP-Series presses can be ordered as factory assembled press frame. Add suffix "M" to press model number. Example: XLP-506XA12G-M.

▼ XLP-25

▼ XLP-50 -XLP-75

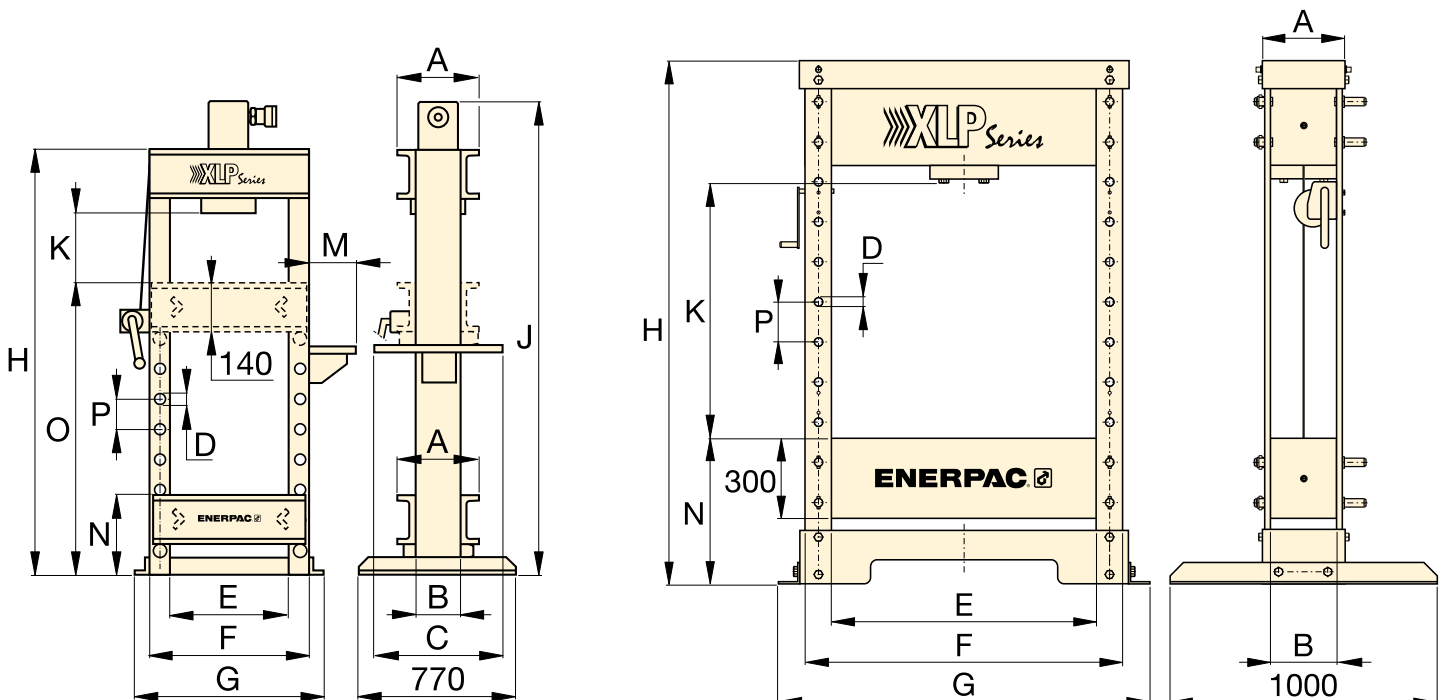

XLP-Series, Hydraulic Workshop Presses

▼ PRESS DIMENSIONS CHART (IN MM)

Press Series	Cylinder Stroke	XLP-25	XLP-50	XLP-75
Capacity ton (kN)		25 (232)	50 (498)	75 (718)
Hand pump	156	XLP-256P392	XLP-506P802	-
Air pump	156	XLP-256XA11G	XLP-506XA12G	XLP-756XA12G
Electric pump	156	-	XLP-506ZES	-
	334	-	XLP-5013ZES	-
Vertical Daylight	-	370 - 858	210 - 940	210 - 940
Horizontal Daylight	-	510	990	990
Bed Width	-	140	240	330
A	-	260	310	420
B	-	140	240	330
C	-	610	-	-
D	-	32	32	40
E	-	510	990	990
F	-	630	1190	1240
G	-	700	1390	1430
H	-	1622	1995	1995
J	-	1740	-	-
K	-	370 - 858	210 - 940	210 - 940
M	-	140 - 323	-	-
N	-	210	540	540
O	-	1070	-	-
P	-	122	150	150
Weight (kg)	-	170	700	900

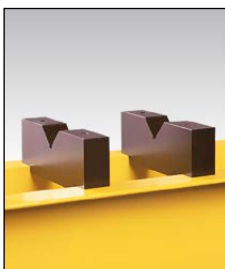

Optional V-Blocks

To facilitate positioning of pipes and bars, or placed upside-down, to serve as a convenient worktable. Featuring precise fit into the press bolster. Each model number includes two V-blocks.

To be used with press (ton)	V-Blocks (set) Model Number
25	VB-25
50	VB-501
75	VB-101

▼ VLP-100 OR 200



VLP-Series Presses



Hydrajust

Allowing effortless daylight adjustment by moving the lower bed up and down
Can be used with presses equipped with double-acting cylinder.



Electric Pumps

ZE-Series, 700 bar Electric Pumps with pendant operated valves provide maximal flexibility in operation of the press cylinder.

- Open frame
- Pump mounted gauge for optimal safety.
- Revolving pump table for optimal flexibility
- “Hydrajust” for lower bed positioning
- Electric pumps with remote valve operation

▼ VLP-100

▼ VLP-200

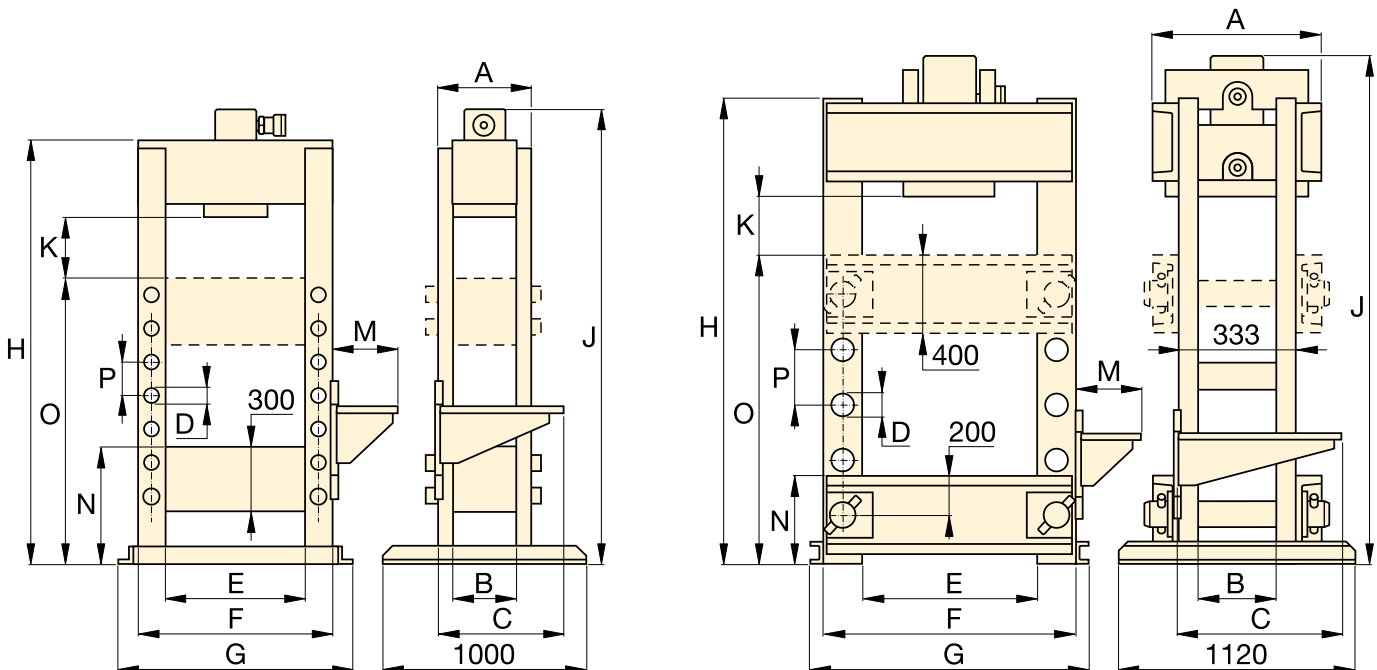

100 and 200 tons Hydraulic Workshop Presses

▼ PRESS DIMENSIONS CHART (IN MM)

Press Series	VLP-100		VLP-200
Capacity ton (kN)	100 (989)		200 (1995)
Cylinder Stroke	168	330	330
Model Number	VLP-1006ZES	VLP-10013ZES	VLP-20013ZES
Vertical Daylight	239 - 989	239 - 989	377 - 1340
Horizontal Daylight	990	990	1220
Bed Width	340	340	553
A	400	400	553
B	340	340	233
C	560	560	560
D	40	40	76
E	990	990	1220
F	1240	1240	1620
G	1400	1400	1740
H	1879	1879	2285
J	1885	2050	2370
K	239	239	377
M	425	425	425
N	540	540	453
O	1290	1290	1415
P	150	150	254
Weight (kg)	970	993	1992

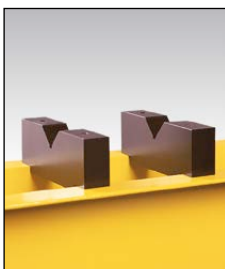

V-Blocks*

To facilitate positioning of pipes and bars, or placed upside-down, to serve as a convenient worktable. Featuring precise fit into the press bolster. Each model number includes two V-blocks.

To be used with press (ton)	V-Blocks (set) Model Number
100	VB-101
200	A-200

* To be ordered separately.